

SP 11
THIS INDENTURE made this seventeenth day of December one thousand nine hundred and eighty namely 1980 BETWEEN the GOVERNOR OF THE STATE OF WEST BENGAL hereinafter referred to as the "DONOR" (which expression shall unless excluded by or repugnant to the context be deemed to include his successors-in-office) of ONE PART; AND SHRI/SMT./KM. Ranjit Lahiri

Son/Wife/Daughter of Lata Hirabai
residing at Chittaranjan Colony

SHRI/SMT./KM.

Son/Wife/Daughter of
residing at

SHRI/SMT./KM.

Son/Wife/Daughter of
residing at

SHRI/SMT./KM.

Son/Wife/Daughter of
residing at

SHRI/SMT./KM.

Son/Wife/Daughter of
residing at

SHRI/SMT./KM.

Son/Wife/Daughter of
Hindu residing at

hereinafter called the "DONEE" (which expression shall unless excluded by or repugnant to the context be deemed to include his/her heirs, executors, administrators, representatives and assigns) of OTHER PART.



WHEREAS after the partition of India a large number of residents of former East Pakistan crossed over and came to the territory of the State of West Bengal from time to time due to force of circumstances beyond their control.

AND whereas the Government of West Bengal (hereinafter referred to as the "Government") offered all reasonable facilities to such persons (hereinafter referred to as "Refugees") for residence in West Bengal.

AND whereas a considerable number of such people were compelled by circumstances to use vacant lands in the urban areas for homestead purposes.

AND whereas the DONEE was one of such persons who had come to use and occupy a piece of land particularly described in the schedule hereunder.

AND whereas the DONEE being a refugee displaced from East Pakistan (now Bangladesh) approached the Government of West Bengal for a plot of land for his rehabilitation.

AND whereas the Government of West Bengal with the intent to rehabilitate the refugees from East Pakistan now Bangladesh acquired land in C.S. Dag No. 658 (P) Mouza Baderaipur in Police Station Jodhpur in the District 24 Parganas in the Urban area under the provisions of L.D.P. Act, 1948/L.A. Act I of 1894 including the plot now in occupation of the DONEE.

AND whereas it has been decided by the Government to make a gift of the said plot of land in favour of the DONEE so as to confer absolute right title and interest in the said land where he has been residing peacefully for a long time more fully described in the schedule hereunder written.

(Urban-acquired-gift)

NOW THIS DEED WITNESSETH that in consideration of the premises hereinbefore mentioned and to provide relief to the DONEE in consideration of his/her destitute condition the DONOR doth hereby absolutely give grant and transfer unto the DONEE ALL THAT PIECE AND PARCEL OF LAND more fully described in the schedule hereunder written as homestead land OR HOWSOEVER otherwise the said land hereditaments and premises are or is at any time or times heretofore were situated butted and bounded as hereinafter described TOGETHER WITH all ways, paths, passages, easements, privileges, appendages and appurtenances whatsoever with all easements thereto and therein TO HAVE AND TO HOLD THE SAID land hereditaments and premises hereby given granted and transferred unto and to the use of the DONEE forever AND THE DONEE shall and may at all times hereafter peaceably and quietly possess and enjoy the said land hereby given granted and transferred subject to the condition that the DONEE shall have no right save as hereinafter provided to alienate or transfer in any way the land comprised in the schedule hereunder written in any manner whatsoever within a period of 10 (ten) years from the date of these presents without obtaining prior written permission of the DONOR which shall not be obligatory on the part of the DONOR to give and which will be granted only in exceptional circumstances of hardship PROVIDED THAT THE DONEE shall be at liberty to mortgage charge or encumber the said land with the Life Insurance Corporation of India or any Nationalised or Scheduled Bank, Co-operative Bank or Government or any Statutory Body or Government Sponsored Financial Institution within this period of ten years for the purpose of construction of a residential building therein and for the purpose of better economic and physical improvement. AND THE DONOR and all persons lawfully and equitably claiming as aforesaid shall and will from time to time and at all times hereinafter at the request and costs of the DONEE do or execute or cause to be done and executed all such acts, deeds and things whatsoever for further better and more perfectly assuring the said messuage land hereditaments and premises and every part thereof unto the DONEE in the manner aforesaid as shall or may be reasonably required.

SCHEDULE

ALL THAT PIECE OR PARCEL OF LAND measuring... 4 K ... 3 ch ... more or less of
 S. P. NO. 615
 homestead land in E/P No. 11 in C.S. Plot No. 658 (P) in Khatian No.
 of Mouza. Baderaipur J. L. No. 34 P. S. Jadarpur
 in the district of 24 Pgs. (S) Sub-Registration Office. Alipore butted and bounded
 in the manner following.

On the North... Colony Road and E. P. - 6

On the East... E. P. - 7

On the South... Tank Plot No 613

On the West... E. P. - 13

SITE PLAN OF E/PLOT NO-11, S/PLOT NO-615, C.S. DAG NO-658(P)
 OF CHITTA RANJAN COLONY IN MOUZA - BADE RAIPUR,
 J.L. NO-34, P.S. JADAVPUR, DIST. 24-PARGANAS(S)

SCALE = 1" = 20'-0"

E/P. NO-11 SHOWN IN RED.

COLONY ROAD

20
25
20
04

E/P NO-6

(76 LINK)

50'-2"

E/P NO-13
(87 LINK)
56'-6"

E/P NO-11
S/P NO-615

BOUNDARY

N - COLONY ROAD & E/P-6

S - TANK PLOT NO-613

E - E/P NO-4

W - E/P NO-13

E/P NO-4
(93 LINK)
62'-6"

52'-2"

(79 LINK)

TANK PLOT NO-613

E/P. NO.	NAME OF THE PLOT HOLDER	SIGNATURE
11	SRI. RANJIT LAHIRI	Ranjit Lahiri
	S/O. LT. HIRALAL LAHIRI	

DRAWN BY
 Allaha
 SURVEYOR

IN WITNESS WHEREOF THE DONOR and THE DONEE have hereunto set and subscribed their respective hands the day, month and year first above written.

Signed and delivered for and on behalf of the Governor

Refugee, Relief and Rehabilitation Department
Government of West Bengal



By the Collector *S. Kumar*
District

In the presence of:
Director of Rehabilitation
R.R. Directorate,
Govt of West Bengal

1st witness *[Signature]*

Address
R.R. Directorate
Govt of West Bengal

Occupation

2nd witness *[Signature]*

Address
R.R. Directorate
Govt of West Bengal

Occupation



29.1.63
2063

Ranjit Lahiri
Signed by the DONEE

1st witness *Mulcul K. Gupta* Occupation *service*

Address *2/33, Chittaranjan Colony, Cal-32*

2nd witness *Surejit Kumar Hora* Occupation *Agency*

Address *2/17, Chittaranjan Colony, P.O. Regent Estate, Calcutta-92*

Checked/Verified,

[Signature]
Surveyor,
R. R. Directorate,
10, Cernac Street,
Calcutta-11

R.B.A. (2) S.G.W.B.
Under Section 88 Act. VIII of 1920

Sapdn
Addl. District Register
Alipore, South 24 Parganas

Sapdn
Addl. District Register
Alipore, South 24 Parganas



11
-1764
Dec 91

Sr. Ranjit Lohin

Sr. Ranjit Lohin

Vol. Hissat Lohin
Chittaranjan Colony
Jadavpur
24 Parganas (S)
Hissat
Rtd.

Sr. Ranjit Lohin

Sr. Ranjit Lohin

Sapdn
Addl. District Register
Alipore, South 24 Parganas

1
23
85-88
1747
91

Sapdn
Addl. District Register
Alipore, South 24 Parganas

Sr. Sujit-Raj Choudhury

Vol. Nalin Mohan
Raj Choudhury
Chittaranjan Colony
Jadavpur
24 Parganas (S)
Hissat
Rtd.

Sujit-Raj Choudhury
Sapdn
Addl. District Register
Alipore, South 24 Parganas

SITE PLAN OF E/PLOT NO - 1, S/PLOT NO - 615, C.S. DAG NO - 652(P)
 OF CHITTA RANJAN COLONY IN MOUZA - BADE RAIPUR,
 S.S. NO - 34, P.S. JADAYPUR, DIST. 24 PARGANAS(S)

SCALE 1:500

E/P. NO - 11 SHOWN IN RED

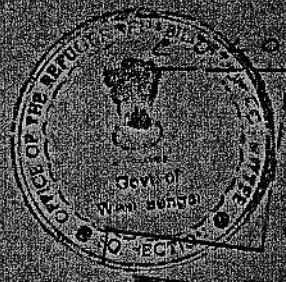

APPROVED

REVENUE
 JADAVPUR

CHECKED & VERIFIED
 SURVEYOR
 GOVT. OF WEST BENGAL

Secretary
 CHITTA RANJAN COLONY
 Jadavpur, Calcutta-100034



BOUNDARY
 N - COLONY ROAD S/P NO - 6
 S - TANK PLOT NO - 613
 E - E/P NO - 11
 W - E/P NO - 13

E/P NO	NAME OF THE PLOT HOLDER	SIGNATURE	K	CH	ST
II	SRI. RANJIT LAHIRI	Ranjit Lahiri	4	03	0
	S/O. LT. HIRALAL LAHIRI				

DRAWN BY
 SURVEYOR

SITE PLAN OF E/PLOT NO-11, S/PLOT NO-615, C.S. DAG NO-658(P)
OF CHITTA RANJAN COLONY IN MOUZA - BADE RAIPUR,
J.L. NO - 34, P.S. JADAVPUR, DIST. 24- PARGANAS(S).

SCALE = 1" = 20'-0"



E/P. NO-11 SHOWN IN RED.

APPROVED
 KANUNGO - I
 R.R. & R. Directorate
 Govt. of West Bengal

CHECKED & VERIFIED
 SURVEYOR
 R.R. & R. Directorate
 Govt. of West Bengal

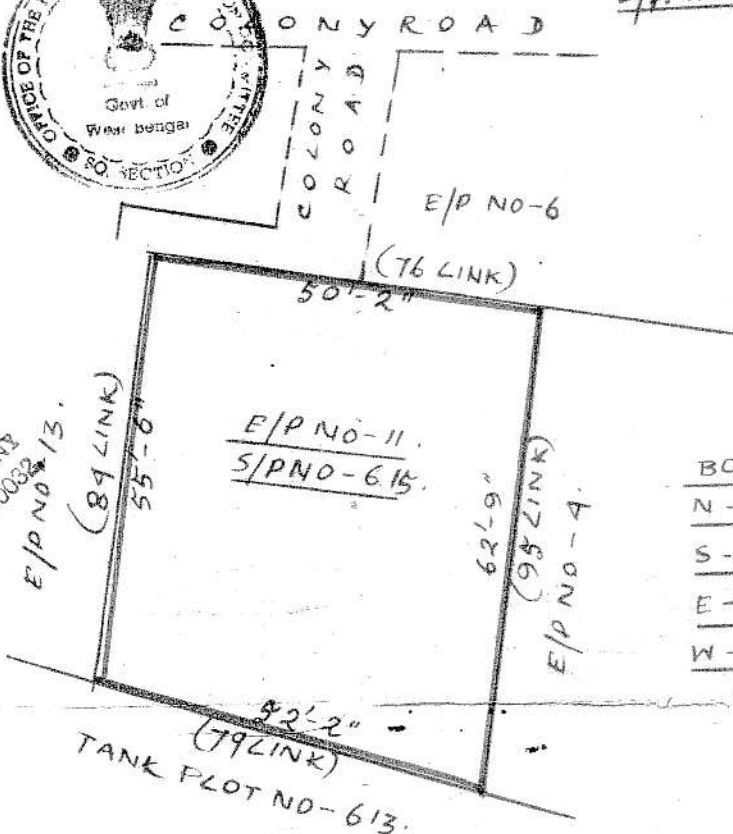

BOUNDARY
 N - COLONY ROAD & E/P - 6
 S - TANK PLOT NO-613
 E - E/P NO-4
 W - E/P NO-13

Secretary,
 CHITTARANJAN COLONY
 Jadavpur, Calcutta-700032

E/P. NO.	NAME OF THE PLOT HOLDER.	SIGNATURE	K.	CH.	SET
11	SRI. RANJIT LAHIRI. S/O. LT. HIRALAL LAHIRI.	Ranjit Lahiri	4	03	C

DRAWN BY,
 Alinda
 SURVEYOR.



Kolkata Municipal Corporation
Building Department
FORM OF BUILDING PERMIT (PART I)

Applicant Details : SRI PRABAL CHOWDHURY AND SRI SWAPAN KUMAR PANDA PARTNERS OF M/S SAP CONSTF

Financial Year	Borough No	BP No	Sanction Date	Premises No	Assessee No	Ward No	Applicant Type
2023	12	2023120149	23-JUN-23	96, CHITTARANJAN COLONY	311020000954	102	Power of Attorney

LBS/Architect/ESE Details :

Licence No	Name
LBS/II/1671	PRATIK DAS
ESE/II/602	SUJAN KUMAR MITRA

Processing Particulars

Under Section	Processing Category	Submission Date	Plan Case No:
393A	NON MBC	30/04/2023	2023120043

Description of Plan Proposal

Use Group	Land Area (Sq mts)	Height (mts)	F.A.R	Width of MA	Total Floor Area	Against proposal (in sqmt)	ground floor area
01	280.033	9.9	1.25	3.415	376.383	376.383	125.461

JJ No E/07/2023/2078 JJ Date 19-JUN-23

Fees Details

Description	Amount
Sanction Fee	11000
Surcharge For Non-Resl Use	0
Infra. Dev. Fees	0
Stacking Fee	5873
Well - Work Charge	7831
Waste Water Charges	3916
Drainage Development Fees	34910
Drainage Observation Fees	680
Water Observation Charge	800
Fees For Survey Obs. Report	7000
Application fee for Submission of Building Plan	5000
Labour/Welfare Cess on Building Sanction Plan	28584
KMDA's Development Charge	0